

CANADIAN TIRE GALLERY

Crypt, 2016

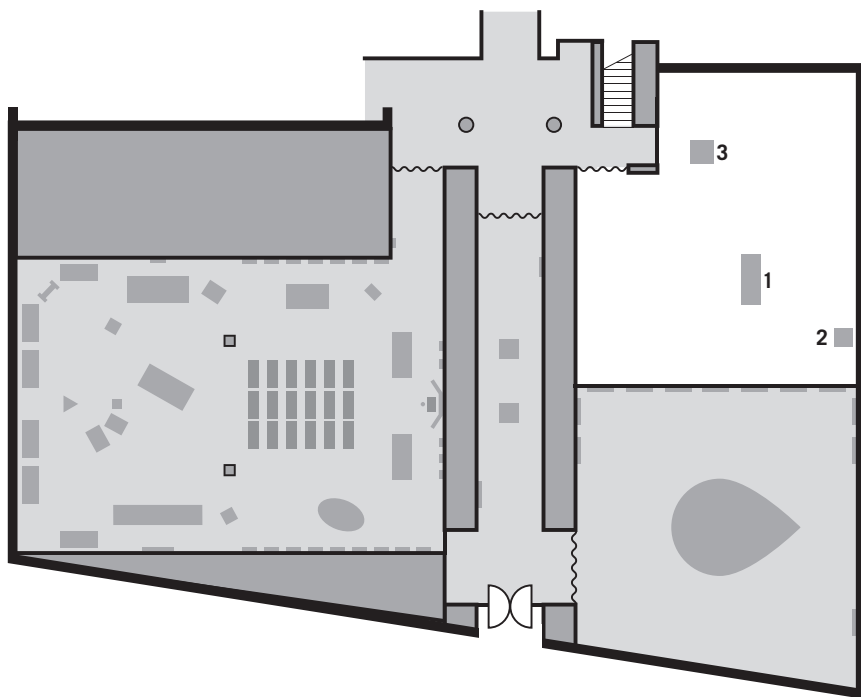

1. *Crypt (Prone)*
2. *Crypt (Seated)*
3. *Crypt (Standing)*

Crypt, 2016

Museum display case, English, c. 1880s

Oak and glass, with brass hardware, key-lock removable side panels and new linen-covered wood risers; stamped "Holland & Sons, Mount Street, London"
69 (h) x 78 1/2 x 28 1.4 inches, 175.3 (h) x 199.4 x 71.8 cm

Artist's articulated life-size manikin, French, 19th century

Hand-carved pine, with wooden ball joints and dowels; incised furrowed brow and eyebrows; dimpled chin; sculpted rib cage; fully jointed and articulated fingers
69 (h) x 20 x 10 inches, 175.3 (h) x 50.8 x 25.4 cm

Artist's articulated life-size manikin, French, early 20th century

Hand-carved wood, with wooden ball joints and steel screw dowels;
stylized anatomical features
66 (h) x 17 x 8 1/2 inches, 167.6 (h) x 43.2 x 21.6 cm
Provenance: Collection of Eugenio Pellini (Italian, 1869–1934), a prominent sculptor in the Scapigliatura movement

Christian rosary, French, mid-19th century

Double strand, pea-beaded rosary suspending brass, three-bar Patriarchal cross and Medal of the Immaculate Conception; brass clip to hold rosary at the waist of traditional Catholic habit, stamped with miniature Medal of the Immaculate Conception design
Overall length: 25 inches, 63.5 cm
Cross: 2 7/8 (h) x 2 7/8 x 1/8 inches, 7.3 (h) x 4.0 x 0.3 cm
Medal of the immaculate Conception: 1 1/2 (h) x 1 1/4 x 1/16 inches, 3.8 (h) x 3.2 x 0.2 cm
Clip: 2 1/2 (h) x 5/8 x 1/2 inches, 6.4 (h) x 1.6 x 1.3 cm

Patriarchal cross bears multiple inscriptions on sides and around the edges

(One side):

"L-J-C"

"J.M.J."

"Térese de Jésus."

"Jean de la Croix."

"Arrête!!!

Le Coeur de Jésus est avec moi."

"Cor Jesu sacratum/Da mihi animas!" (Most Sacred Heart of Jesus/Give me Souls!)

"F. Théodore, Marie du Saint Sacrement. C.D."

(Other side):

†
Z
†
D – I – A
†
B
I
Z. †. S. A. B. †. Z. †. H.
G
F
†
B
F
R
S
“Jésus et Marie.”

(Around the top edges):

“aut pati aut mori” (Either to Suffer or to Die)

Motto of Saint Teresa of Ávila, also called Saint Teresa of Jesus, 16th-century Spanish Carmelite nun, founder of the Discalced Carmelites

“pati et contemni pro te” (To Suffer and Be Despised for You)

Motto of St. John of the Cross, 16th-century Spanish Carmelite friar, founder of the Discalced Carmelites

(Side edges):

“A.M.D.G.” (Ad maiorem Dei gloriam/For the Greater Glory of God—motto of the Society of Jesus (Jesuits))

“ST. OMER” (Saint Audomar)

Dates: 1828–1839; 1853–1855; and 1861

(Bottom edge):

“Christus omnia in omnibus” (Christ is All and in All)

Santos figure holding beeswax candle, Italian, c. 18th century

Hand-carved wood, with removable head; torso and floor-length skirt carved from single block of wood; articulated at shoulders and elbows; clasped hands carved together holding a lit 12-inch (30.5 cm) beeswax candle between palms

Displayed on a painted plinth

Figure: 59 (h) x 20 x 16 inches, 149.9 (h) x 50.8 x 40.6 cm

Plinth: 24 (h) x 36 x 36 inches, 61.0 (h) x 91.4 x 91.4 cm

Originally made as a site-specific extension of *From her wooden sleep...*, Crypt has been reimagined for this exhibition to include a Santos figure holding a beeswax candle. The manikins lying in the vitrine and seated on the floor are life-size versions of smaller figures in *From her wooden sleep...*. The figure on the floor, leaning against the wall and sharing the space with the viewer, has modernist, stylized shoulders, hands and feet. The futuristic figure also has no recognizable facial features.